

MEGA CONSTRUCTION STARTER WORKSHOP

- Please **READ** these instructions first, it only takes a few minutes,
- This sheet explains how to use the tools and explains the symbols used in the project instructions.
- You can also go to www.megaconstruction.co.uk to see a video of how to use the tools and watch each model being built up piece by piece which you can pause and rewind.



All the tools are completely safe and are designed for cutting foam tubes.

The models are made up from 3 tube sizes, you will see these referred to as **L** for large, **M** for Medium and **S** for small.

TOOLS

<h4>MEASURE</h4> <p>END STOP, BASE RULER, JOIN RULER TOGETHER</p>	<h4>SAW CUTTING</h4> <p>MITRE BLOCK, HACKSAW, INSERT FOR SMALL TUBE, INSERT FOR MEDIUM TUBE</p>	<h4>HOLE CUTTING</h4> <p>NOT USED IN STARTER SET</p> <p>LARGE TUBE (BLACK), LARGE TUBE JIG, MEDIUM HOLE CUTTER, MEDIUM TUBE JIG, SMALL HOLE CUTTER, MEDIUM TUBE HOLDER, FOAM INJECTOR</p>	<h4>SLOT PUNCHING</h4> <p>NOT USED IN STARTER SET</p> <p>INSERT FOR LARGE TUBE JIG</p>
---	---	--	---

SAW CUTTING

L LARGE TUBES

NOT USED IN STARTER SET

PUSH TUBE TO TOUCH END STOP

TOP TIP: Check twice, cut once!

ALIGN THE POINT TO THE RULER MEASUREMENT SHOWN IN THE TUBE CUTTING GUIDES

M MEDIUM TUBES

ADD THE MITRE INSERT FOR THE MEDIUM TUBE

S SMALL TUBES

ADD THE MITRE INSERT FOR THE SMALL TUBE

- When cutting, hold the tube steady with your free hand.
- On the back of this sheet you will find the tube cutting guide for your project.
- **Before cutting each length, DOUBLE CHECK** you have the right size tube and the pointer is at the correct measurement.
- Put the corresponding sticker on the end of the tube after each piece is cut.

HOLE CUTTING - MATCH THE ORANGE AND BLACK COLOUR TOOLS TO THE INSTRUCTIONS

L LARGE TUBES

NOT USED IN STARTER SET

START WITH ARROW AT 0

USE BLACK CUTTER FOR MEDIUM HOLES

ROTATE TO CUT

USE ORANGE CUTTER FOR SMALL HOLES

ADD SMALL INSERT

ALIGN THE POINT TO THE RULER MEASUREMENT SHOWN IN THE INSTRUCTIONS

IF THIS SYMBOL IS SHOWN ROTATE THE TUBE, IN THE DIRECTION INDICATED, BEFORE THE NEXT STEP

USE BLACK TUBE HOLDER

60mm

M MEDIUM TUBES

USE ORANGE TUBE HOLDER

USE ORANGE CUTTER FOR SMALL HOLES

STOP HERE FOR CUTTING HALF WAY THROUGH **L** TUBE

STOP HERE FOR CUTTING HALF DEPTH **L** TUBE FULL DEPTH **M** TUBE

PUSH OUT WASTE AFTER DRILLING

DRILL ALL THE WAY THROUGH

DRILL HALF WAY THROUGH

TO ASSEMBLE TWIST THE TUBE LEFT AND RIGHT AS YOU PUSH IT THROUGH THE DRILLED HOLE

TOP TIP: When cutting half depth medium holes, drill a small hole first, then a medium. You can use your finger to pull the remaining ring out.

- You can drill **Medium and Small holes** in the **L** Large tube and **only small holes** in the **M** Medium tube, you **CANNOT drill holes in the Small tube**.
- **Before** you cut each hole **DOUBLE CHECK** the tube holder arrow is in the correct position (0, 1, 2 or 3), the pointer is on the correct measurement, you have the correct drill size and the depth the drill needs to go.

PUNCHING SLOTS

(L) LARGE TUBES
NOT USED
IN STARTER SET

(M) MEDIUM TUBES

ALIGN THE POINT TO THE
RULER MEASUREMENT
SHOWN IN THE
INSTRUCTIONS

STOP AT
THIS MARK

INSERT
ADAPTER

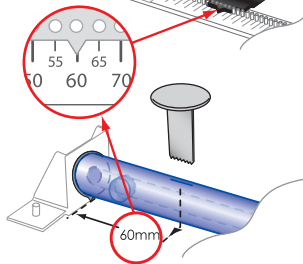

TOP TIP - Go to
megaconstruction.co.uk
to see videos of how to
use the tools & step by
step model build up.

CARD PIECES

Carefully push out the pieces from the sheets folding the pieces on the creased lines as indicated and adding to the model when and where indicated.

PLEASE NOTE:
These pieces may not be in your set,
images are a guide only.

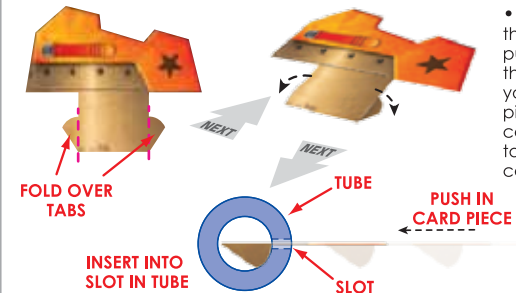

Fold the edges of the tabs over and push carefully into the slot making sure you have the card piece facing the correct way. The tabs will lock the card piece in place.

MOTOR CROSS

TUBE CUTTER GUIDE - START YOUR PROJECT BY CUTTING THE TUBES

BLUE STAGE 1

GREEN STAGE 2

RED STAGE 3

• Cut all tubes to the correct length as shown here.

• Use each size & length as indicated to ensure you don't run out of tube.

• Place a sticky label on each corresponding tube (after each cut) as you will need this reference when it comes to the construction of your model.

• Divide your tubes into 4 piles according to colour of sticker, these relate to the 4 stages, as you will not need all the tubes at once.

• Alternatively you can cut the tube for each stage at the time of construction but you will need to remember which tube has been cut.

The best way to remember is to put the sticker of the next piece to be cut on the end of the remaining tube.

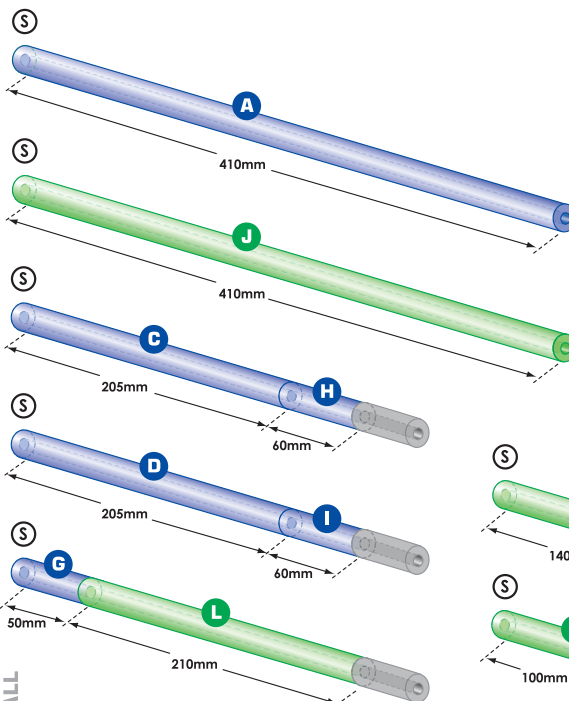
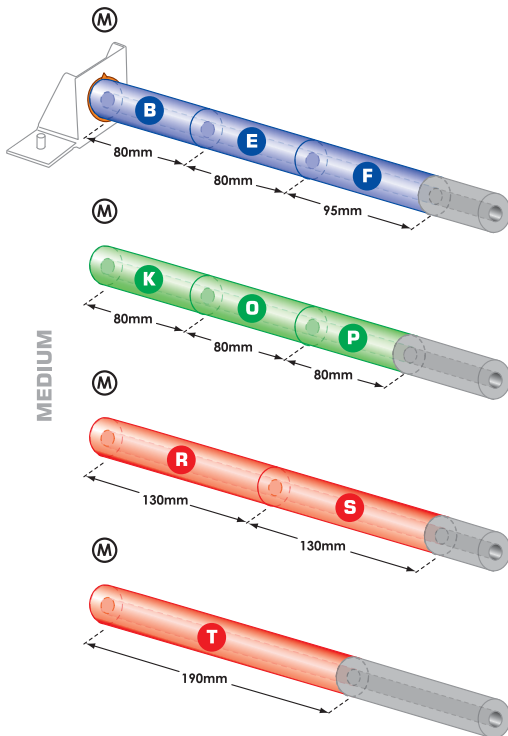

PARTS

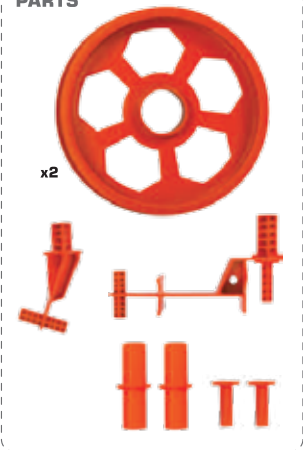

WARNING. Not suitable for children under 36 months. Choking hazard - can form small parts. Adult supervision required. Only use the tools as instructed. Never use real saws, drills or other cutting devices.

John Adams are constantly endeavouring to improve quality standards and therefore colours, sizes and contents may sometimes vary from those shown.

©2013 John Adams Leisure Ltd. Please retain this information. Manufactured in China. John Adams Leisure Ltd., Marketing House, Blackstone Road, Huntingdon, Cambs, PE29 6EF, UK. Customer Service Tel: 01480 414361 or Email customerservices@johnadams.co.uk. To see more of our range why not visit www.johnadams.co.uk