

**STAGE 1
DRILL**

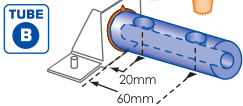

NEXT

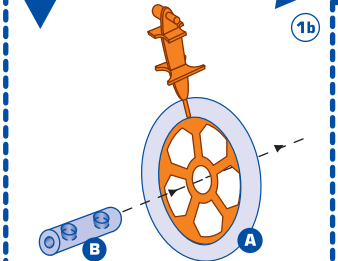

1a

NEXT

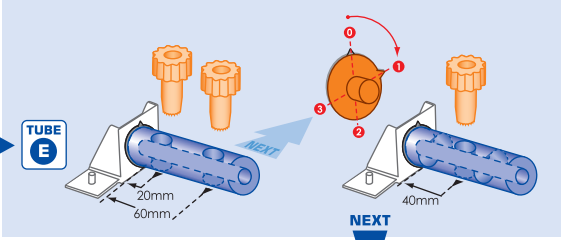

1b

NEXT

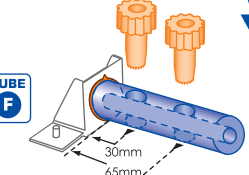

1c

NEXT

ASSEMBLE THESE PIECES

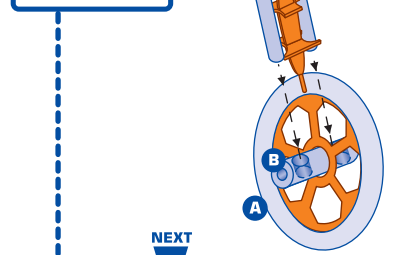

NEXT

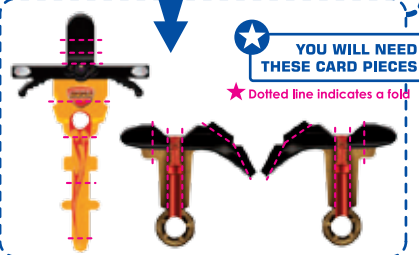

YOU WILL NEED THESE CARD PIECES
★ Dotted line indicates a fold

ASSEMBLE THESE PIECES TO CONSTRUCT THE FRONT WHEEL

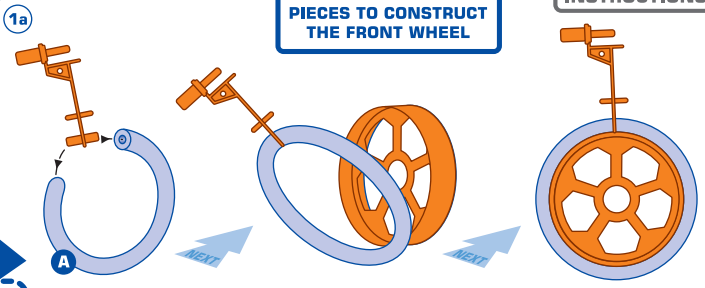

1a

NEXT

MOTOR CROSS INSTRUCTIONS

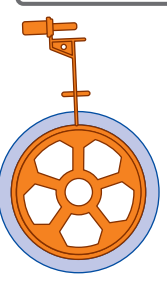

ASSEMBLE THESE CARD PIECES ONTO YOUR MODEL

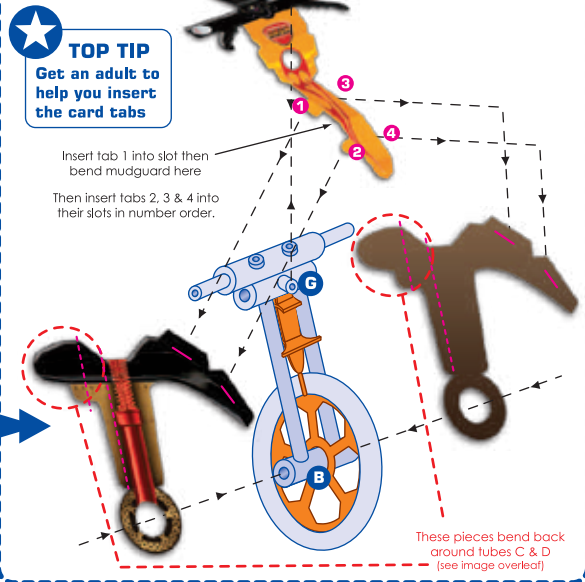

1d

TOP TIP
Get an adult to help you insert the card tabs

Insert tab 1 into slot then bend mudguard here
Then insert tabs 2, 3 & 4 into their slots in number order.

These pieces bend back around tubes C & D (see image overleaf)

STAGE 1 continued overleaf

STAGE 1 cont...

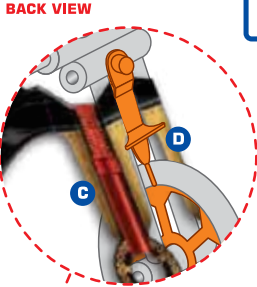

BACK VIEW

Card pieces bend back around tubes C & D and tuck in as shown

YOUR MODEL SHOULD LOOK LIKE THIS



✓

STAGE 1 COMPLETE

ASSEMBLE THESE PIECES TO CONSTRUCT THE REAR WHEEL

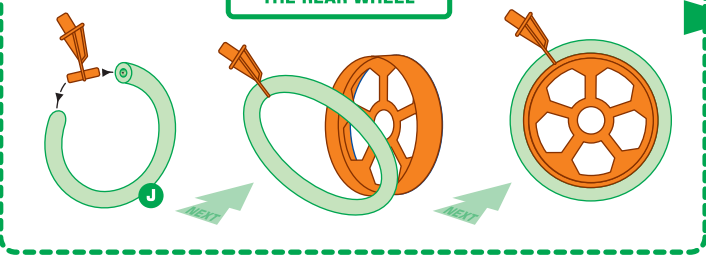

2a

NEXT

**STAGE 2
DRILL**

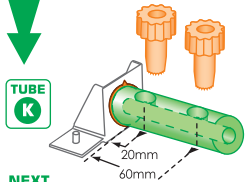

NEXT

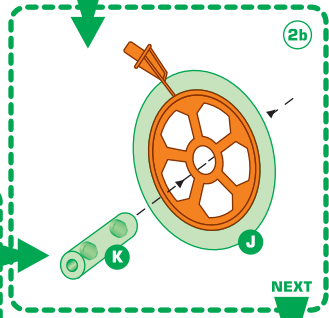

2b

NEXT

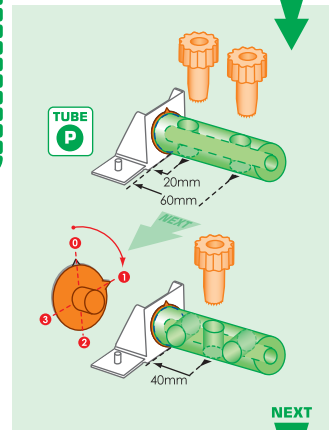

2c

NEXT

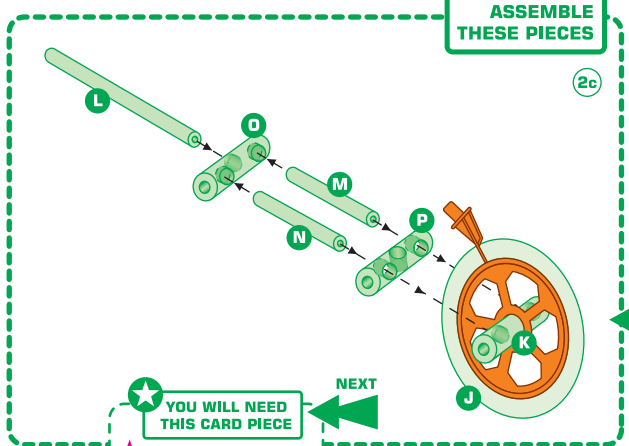

ASSEMBLE THESE PIECES

2c

YOU WILL NEED THIS CARD PIECE
★ Dotted line indicates a fold

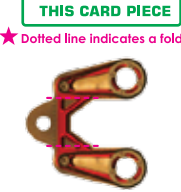

STAGE 2 continued overleaf

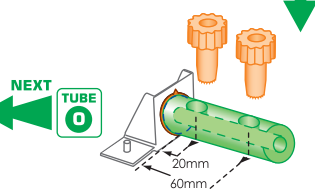

NEXT

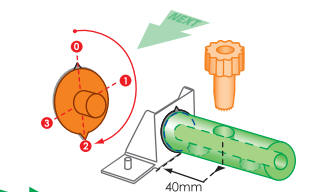

NEXT

STAGE 2 cont...

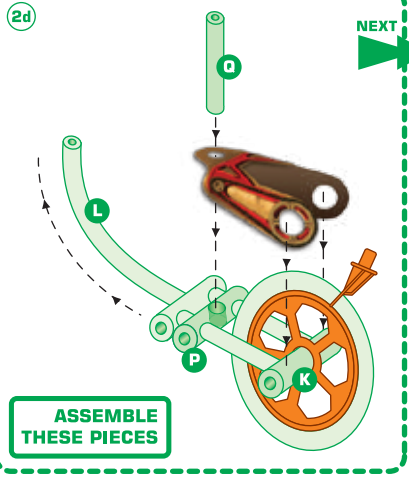

STAGE 2 SHOULD LOOK LIKE THIS

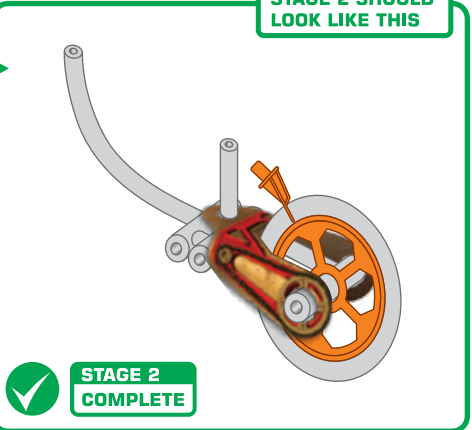

STAGE 3 DRILL

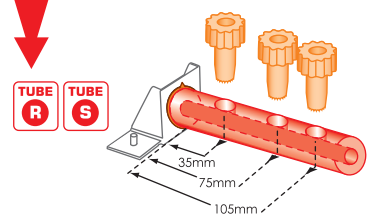

NEXT

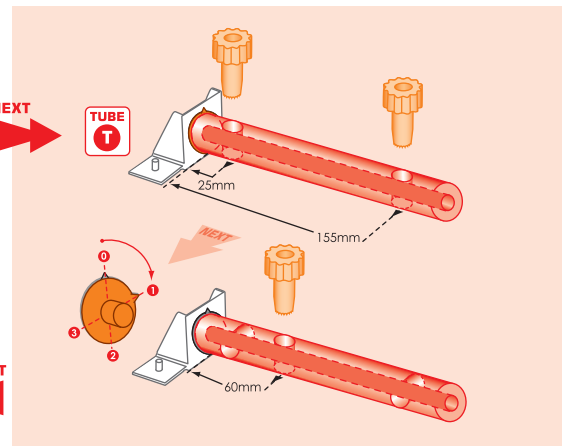

ASSEMBLE THESE PIECES

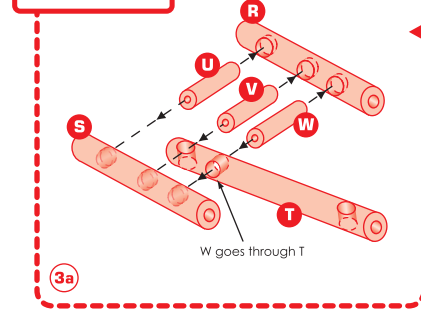

NEXT

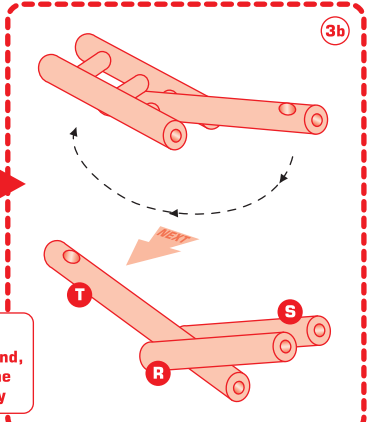

TOP TIP
Turn this section around, as shown, ready for the next stage of assembly

STAGE 3 cont...

YOU WILL NEED THESE CARD PIECES
★ Dotted line indicates a fold

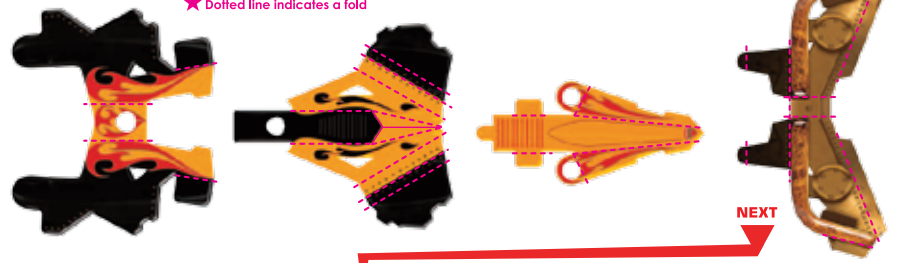

Fold card piece round and insert tab into slot



ASSEMBLE REMAINING CARD PIECES ONTO YOUR MODEL

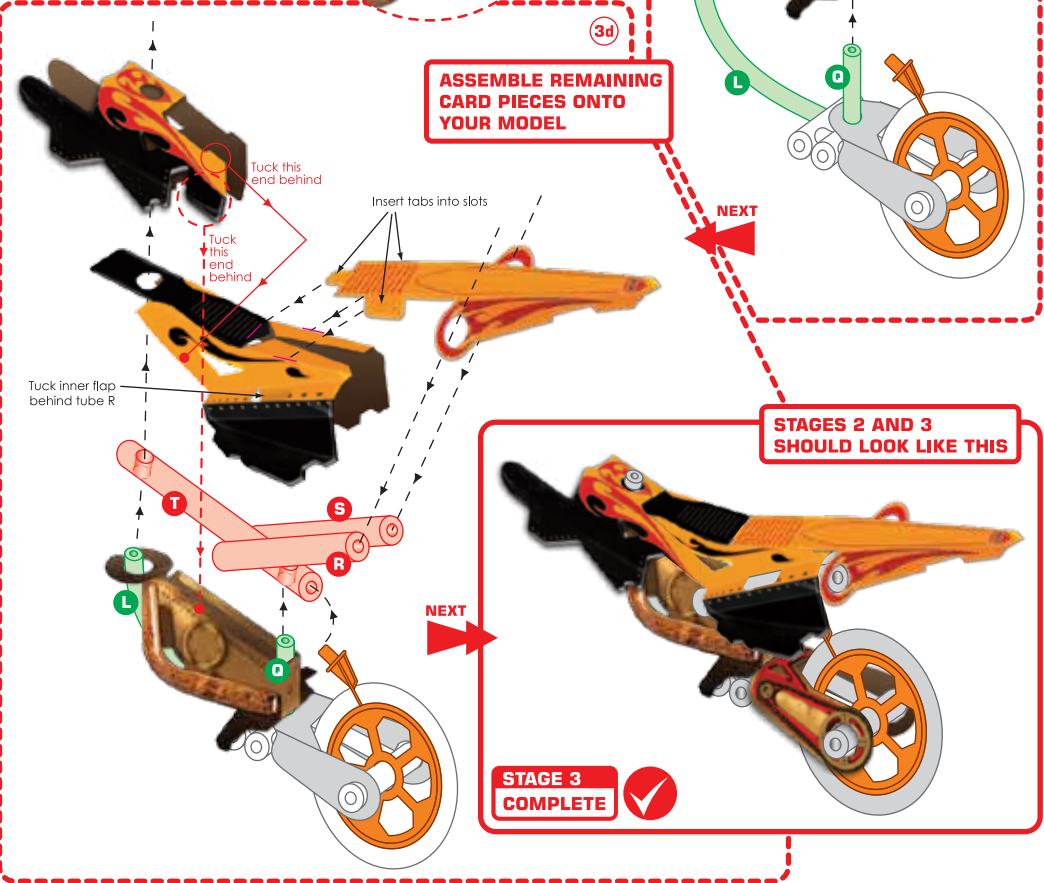

ASSEMBLE THESE PIECES

STEP 4 COMPLETE

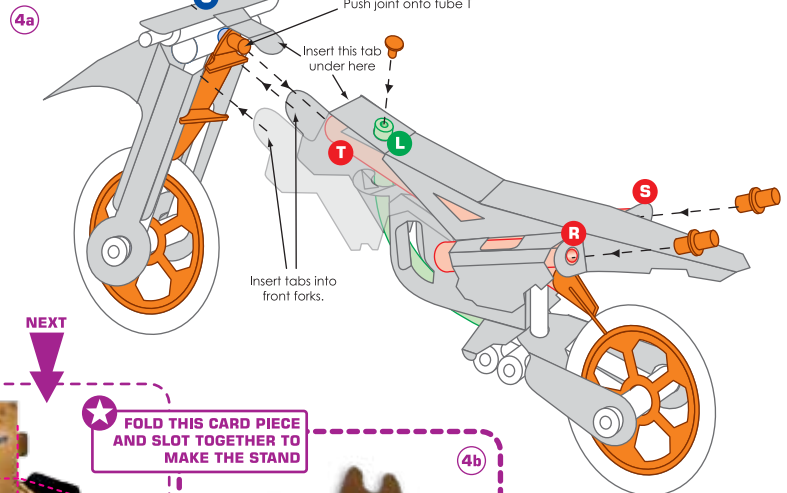

NEXT

FOLD THIS CARD PIECE AND SLOT TOGETHER TO MAKE THE STAND

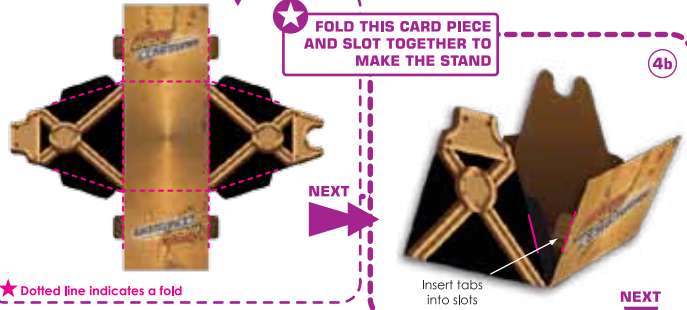

NEXT

NEXT

YOUR MODEL SHOULD LOOK LIKE THIS



MOTOR CROSS COMPLETE

